

Outdoor Mini Bullet

Product Guide

OVERVIEW

The Outdoor Mini Bullet is a high-performance mini bullet camera optimized for outdoor video monitoring. Its compact design and outstanding 1080 p HD quality video make the camera ideal for both commercial and residential video installations. The camera features a dust-resistant exterior casing with an IP 67 rating and Power over Ethernet (PoE) capabilities.



INCLUDED MATERIALS

- Mini Bullet camera
- Camera stand
- Mounting hardware
- Drill template
- Hex key (Allen wrench)
- Water-resistant cap
- Mounting screws and anchors (x 3)

REQUIREMENTS

Power

Wi-Fi (2.4 or 5 GHz) connection to broadband (Cable, DSL, or Fiber Optic) Internet.

Device

Computer, tablet, or smartphone with Wi-Fi.

Mobile App

Download the latest Alarm.com Mobile App for iOS or Android (version 4.4.1 or higher for video streaming).

Service Plan

Additional monthly costs may apply.

DEVICE BENEFITS

- Outdoor video monitoring
- Compact design

DEVICE FEATURES

- 1080 p HD video
- Power over Ethernet
- IR night vision
- IP 67 - rated waterproof and dust tight

Need Help?

HOW TO FACTORY RESET THE OUTDOOR MINI BULLET TO ITS DEFAULT SETTING

Resetting a video device to its factory defaults removes all programming and memory from the device. This is useful for troubleshooting and reusing equipment.

Reset Procedure:

1. Remove power from the device.
2. Use the hex key that comes with the Mini Bullet camera to remove the water-tight door on the bottom of the camera to reveal the reset button.
3. Press and hold the **Reset** button while reconnecting power.
4. After connecting power, continue to hold the **Reset** button for 10 seconds.

Reset Button Location:

The **Reset** button can be found on the back of the camera.

Reset Button Image:

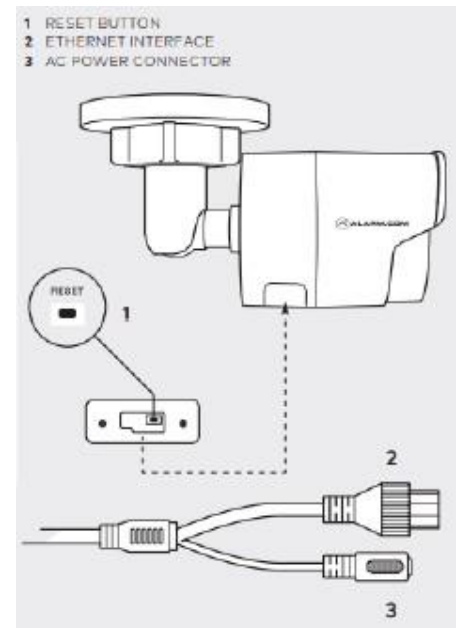

Once a video device is reset, it is normal for the LED to turn off momentarily.

Note: Leave the video device powered on and undisturbed for two minutes after performing a factory reset to ensure that the device finishes resetting.

How does the Outdoor Mini Bullet connect to the internet?

The Outdoor Mini Bullet can be connected to the Internet with an Ethernet cable. When Power over Ethernet (PoE) is used, the power and internet connection are both supplied through the Ethernet cable by a PoE compatible networking device.

Are there status LEDs on the Outdoor Mini Bullet?

No. There are no LED status lights on the Outdoor Mini Bullet. The only lights that illuminate are the IR LEDs.

ETHERNET CAPABILITIES

Important: To use this video device without PoE, an AC adapter must be purchased separately. Ask your Trinity representative about compatible AC adapter.

<p>Image of Ports:</p> 	<p>Available Ports:</p> <ul style="list-style-type: none"> • Ethernet • 2.1 millimeter DC 	<p>Connection Options:</p> <ul style="list-style-type: none"> • If Power over Ethernet is available, use the Ethernet port for power and data. • If Power over Ethernet is unavailable, use an AC adapter for power and an Ethernet cable for data.
--	--	--

WIRELESS CAPABILITIES

The Outdoor Mini Bullet is incompatible with Wi-Fi; it is a hardwired only device. However, the video device can be used in conjunction with the Outdoor Mini Bullet PoE bridge to allow the ability for the camera to communicate over Wi-Fi. For additional questions and information, contact your Trinity representative.